



durlings

chartered surveyors  
and property consultants

**65 Camden Road • Tunbridge Wells • Kent TN1 2QE**  
**Commercial Premises - To Let - 647 sq ft.**

## Location

This property is in a town centre position, close to The Royal Victoria Place Shopping Mall in an area known as "The Camden Quarter," which includes a wide range of independent retailers, restaurants, and bars, yet just a short walk away from the main 'high street' shopping areas of town. Tunbridge Wells main line train station is a 10-minute walk (0.4 miles). There is easy access to public parking the closest being the multi storeys in Royal Victoria Place and Crescent Road.

## Description

Corner premises, formerly a pub, and more lately a tattoo parlor, and suitable for a variety of alternative uses. Front and rear retail areas. Side ancillary retail / office space. To the rear is a kitchen and WC (not measured) with access out to a rear yard. Floor plans are available on our website listing.

## Floor Area

**647 sq ft** (60.11 sq m) – overall (excluding kitchen and wc area)

## Rent

**£15,500 per annum**, exclusive of all other outgoings.

## Terms

New lease by arrangement.

## Business Rates

The ratable value is £14,500. Interested parties are advised to check the amount payable for the year directly with Tunbridge Wells Borough council – 01892 526121.

## Viewing Arrangements

Strictly by appointment and accompanied.

T – 01892 552500

Rupert Farrant – [rupert@durlings.co.uk](mailto:rupert@durlings.co.uk)



## Important Note:

**Property Misdescriptions Act:** DURLINGS for themselves and for the vendors or lessors of this property whose agents they are, give notice that:

- (i) These particulars are set out as a general outline only for the guidance of intending purchasers or lessees and do not constitute, nor constitute part of, an offer or contract;
- (ii) All dimensions, distances and areas are approximate, and references to condition and necessary permissions for use and occupation and other details are given in good faith and are believed to be correct, but any intending purchasers or tenants should not rely on them as statements or representations of fact but must satisfy themselves by inspection or otherwise as to the correctness of each item.
- (iii) No person in the employment of DURLINGS has any authority to make or give representation or warranty whatsoever in relation to this property. VAT: Rents, Prices or any other charges quoted are exclusive of VAT, unless stated to the contrary.
- (iv) Prospective purchasers or tenants are strongly recommended to satisfy themselves as to the working order of the main services, various electrical or gas appliances, plumbing, drainage, alarm or other systems or appliances. Whilst these may be mentioned in the particulars, they have not been tested by the Agents.
- (v) Whilst we endeavor to make our sales/letting particulars as accurate and reliable as possible, if there is any point which is of particular importance to you please contact the agents and we will be pleased to check the information, particularly if you are proposing to travel some distance to view the property.

Subject to contract.

Subject to accounts and references.

A rent deposit will be required.

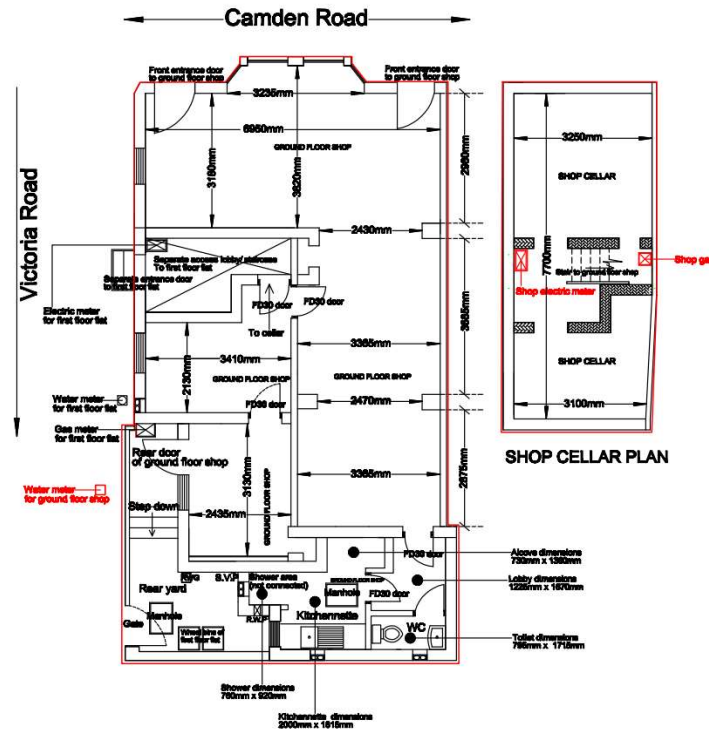

**chartered surveyors  
and property consultants**

**COMMERCIAL**

Contact Rupert Farrant  
or Julie Chalmers on  
**01892 552 500**

[rupert@durlings.co.uk](mailto:rupert@durlings.co.uk)  
[julie.chalmers@durlings.co.uk](mailto:julie.chalmers@durlings.co.uk)  
[www.durlings.co.uk](http://www.durlings.co.uk)



22 Mount Ephraim Road  
Tunbridge Wells  
Kent TN1 1ED